

CALMORE

Hinges
Hardware
& Mixers

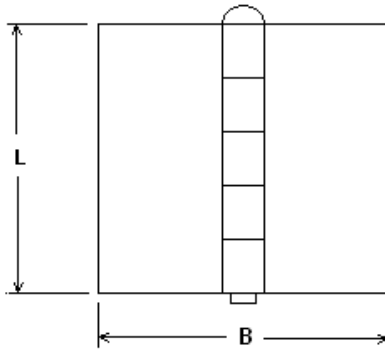

Code no. 30 ROLLED BUTT HINGES

With riveted pin
Self colour, no holes

Options

- Hinge Material steel or stainless steel



NARROW HINGES

Code	Length = L	Width = B	Thickness	Material
30-010A	40	26	0.9	Steel
30-010B	50	31	1.2	Steel
30-010C	60	34	1.4	Steel
30-010D	80	41	1.5	Steel
30-010E	100	52	1.6	Steel
30-010F	40	60	1.2	STST
30-010G	50	31	1.0	STST



HALF WIDTH HINGES

30-020A	60	46	1.4	steel
30-020B	80	58	1.5	steel
30-020C	60	46	1.2	STST



SHARP EDGE HINGES

30-030A	30	30	0.9	steel
30-030B	40	40	0.9	steel
30-030C	50	50	1.2	steel
30-030D	60	60	1.4	steel
30-030E	100	100	1.6	steel
30-030F	40	40	0.9	STST
30-030G	80	80	1.5	steel

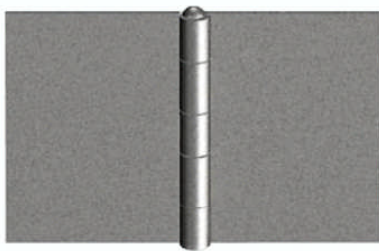

FULL WIDTH HINGES

30-040A	30	45	0.9	steel
30-040B	40	60	1.2	steel
30-040C	50	75	1.2	steel
30-040D	60	90	1.4	steel
30-040E	60	90	1.2	STST

Dimensions mm