



Code no. 99-06
STAINLESS STEEL 'D' HANDLES

TUBULAR SECTION BOLT ON PULL HANDLES

Options

- Material stainless steel (ST/ST) 304 grade
- Finishes polished = P, satin= S
- Roses to suit tubular section pull handles

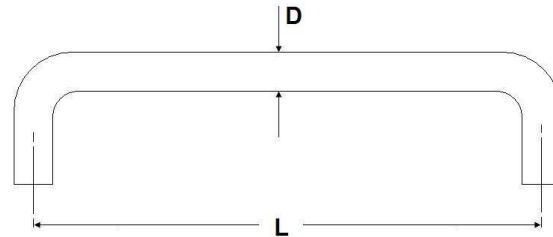

Code	Handle Diameter = D	Length = L	Material	Finish S=satin P= polished
99-06001	19	150	STST 304	S, P
99-06002	19	225	STST 304	S, P
99-06003	19	300	STST 304	S, P
99-06004	19	425	STST 304	S, P
99-06005	19	600	STST 304	S, P
99-06006	22	225	STST 304	S, P
99-06007	22	300	STST 304	S, P
99-06008	25	225	STST 304	S, P
99-06009	25	300	STST 304	S, P
99-06010	25	425	STST 304	S, P
99-06011	25	600	STST 304	S, P

ROSES TO SUIT TUBULAR SECTION PULL HANDLES

Code	Handle Diameter = D	Rose diameter	Rose Thickness	Material	Finish S=satin P= polished
99-0603R	19	50	5	STST 304	S, P
99-0605R	22	50	5	STST 304	S, P
99-0606R	25	50	5	STST 304	S, P

Dimensions are approximate and may vary

Dimensions in mm

Code no. 99-06
STAINLESS STEEL 'D' HANDLES
SOLID SECTION BOLT ON PULL HANDLES
Options

- Material stainless steel (ST/ST) 304 grade, 316 grade
- Finishes polished = P, satin= S
- Roses to suit solid section pull handles

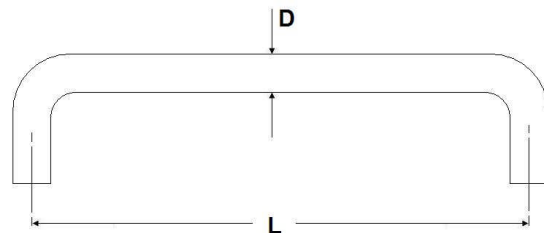

Code	Handle Diameter = D	Length = L	Material	Finish S=satin P= polished
99-06012	16	150	STST 304	S
99-06013	16	225	STST 304	S
99-06014	16	300	STST 304	S
99-06015	19	150	STST 304	S, P
99-06016	19	150	STST 316	S, P
99-06017	19	225	STST 304	S, P
99-06018	19	225	STST 316	S, P
99-06019	19	300	STST 304	S, P
99-06020	19	300	STST 316	S, P
99-06021	19	400	STST 304	S, P
99-06022	19	425	STST 304	S
99-06023	19	600	STST 304	S, P
99-06024	22	225	STST 304	S, P
99-06025	22	300	STST 304	S, P
99-06026	25	425	STST 304	S, P
99-06027	25	600	STST 304	S, P

ROSES TO SUIT SOLID SECTION PULL HANDLES

Code	Handle Diameter = D	Rose diameter	Rose Thickness	Material	Finish S=satin P= polished
99-0602R	16	50	5	STST 304	S
99-0603R	19	50	5	STST 304	S, P
99-0604R	19	50	5	STST 316	S, P
99-0605R	22	50	5	STST 304	S, P
99-0606R	25	50	5	STST 304	S, P

Dimensions are approximate and may vary

Dimensions in mm



Code no. 99-06
ALUMINIUM 'D' HANDLES
SOLID SECTION BOLT ON PULL HANDLES

- Options
- Material
 - Finishes

Aluminium
polished = P, satin= S

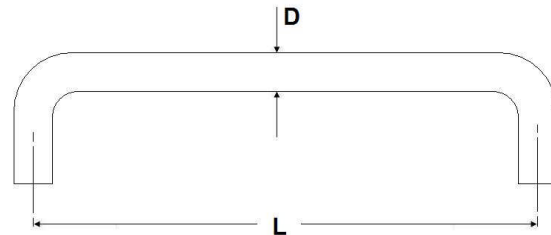

Code	Handle Diameter = D	Length = L	Material	Finish S=satin P= polished
99-06028	10	100	Aluminium	S
99-06029	10	150	Aluminium	S
99-06030	19	150	Aluminium	S, P
99-06031	19	225	Aluminium	S, P
99-06032	19	300	Aluminium	S, P
99-06033	19	425	Aluminium	S
99-06034	19	600	Aluminium	S
99-06035	22	225	Aluminium	P
99-06036	22	300	Aluminium	P



SOLID SECTION CONCEALED FIX PULL HANDLES ON ROSES

Code	Handle Diameter = D	Length = L	Material	Finish S=satin P= polished
99-06055	19	150	Aluminium	S, P
99-06056	19	225	Aluminium	S, P
99-06057	19	300	Aluminium	S, P
99-06058	22	225	Aluminium	P
99-06059	22	300	Aluminium	P

Dimensions are approximate and may vary

Dimensions in mm

Code no. 99-06
STAINLESS STEEL 'D' HANDLES



**SOLID SECTION BOLT ON PULL HANDLES
BACK TO BACK**

Options

- Material stainless steel (ST/ST) 304 grade, Aluminium
- Finishes polished = P, satin= S
- Roses to suit solid section pull handles

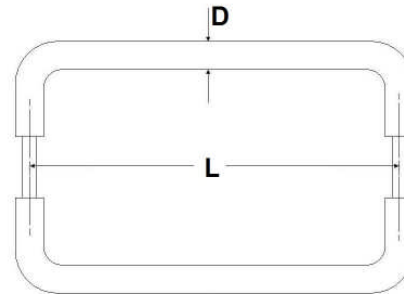

Code	Handle Diameter = D	Length = L	Material	Finish S=satin P= polished
99-06520	19	150	STST 304	S, P
99-06521	19	225	STST 304	S, P
99-06522	19	300	STST 304	S, P
99-06523	19	650	STST 304	S
99-06524	22	225	STST 304	S, P
99-06525	22	300	STST 304	S, P
99-065A1	19	150	Aluminium	P
99-065A2	19	225	Aluminium	S, P
99-065A3	19	300	Aluminium	S, P
99-065A4	22	225	Aluminium	P
99-065A5	22	300	Aluminium	P



ROSES TO SUIT SOLID SECTION PULL HANDLES

Code	Handle Diameter = D	Rose diameter	Rose Thickness	Material	Finish S=satin P= polished
99-0653R	19	50	5	STST 304	S, P
99-0655R	22	50	5	STST 304	S, P

Dimensions are approximate and may vary

Dimensions in mm